

1

2

A

A

B

B

C

C

技术要求:

1.所有印刷颜色均为黑色 :PANTONE BLACK C

2.纸张规格为A5

3.如果供应商的排版需要加空白页，请加在封底前

D

D

						中英文用户手册	6720601728	
						HAMDWQP42601SA PC		
						(2601A)(MIDEA)台湾		
标记	处数	分区	更改文件号	签名	日期	阶段标记	比例	
编制				校对		REV 00	1:1	
审核				性能		数量	重量	
审定				排版		1		
批准				日期		共 1 张	第 1 张	
						80G双胶		
						佛山市顺德区美的		
						洗涤电器制造有限公司		

1

2

**HAMDWQP42601SA PC**

**洗碗機**

**說明書**



# 快速指南

具體操作方法見說明書的相應內容。

## 電源連接

電源為110V AC 60Hz

插座規格為10A 110V AC

排水管連接：將排水管末端放入水槽或水桶。

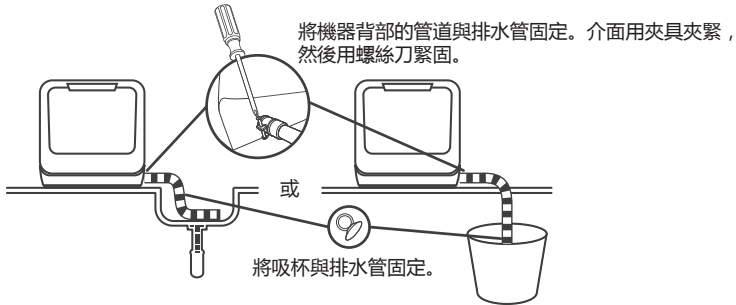

## 清理大塊殘渣

放入碗盤前，請先清理大塊殘渣。

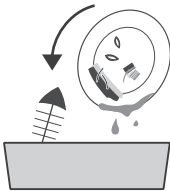

## 打開機門，將碗盤放入，然後加入洗滌劑

按碗盤大小順序從兩側向中間放置。各種刀叉餐具建議傾斜放置，以提高清潔效果。

刀叉餐具放置不當時，噴臂可能會被堵塞，導致清潔效果不理想。

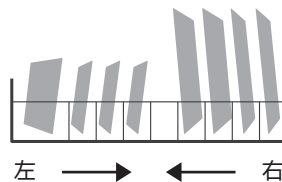

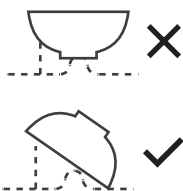

不要將刀叉餐具放在右側，否則可能影響清潔效果。儘量將髒污的一面朝向噴射臂。

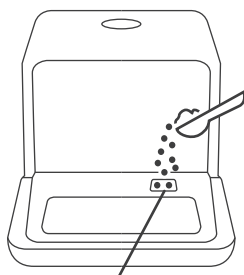

添加洗滌劑的位置（蔬果清潔時不加洗滌劑）。

## 往洗碗機的水箱加水

往水箱加水有兩種方式：

- ① 將進水管與水龍頭連接；
- ② 打開蓋子，手動往洗碗機水箱里加水。

水箱水滿後有兩種提示。

### 1. 啟動前：

水箱水滿後，機器會響起“滴滴滴滴”的聲音。

### 2. 啟動後：

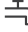
水不滿時， 亮起；

水滿時， 燈不亮，機器會響起“滴滴滴滴”的聲音。

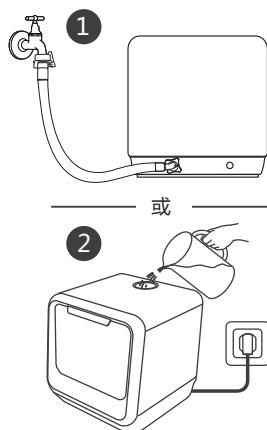

關閉機門，選擇程式，啟動洗碗機。

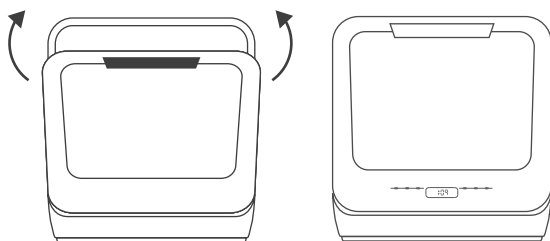

# 目錄

使用洗碗機前，請仔細閱讀本說明書，它可以幫助你正確使用和維護洗碗機。

01	05	<b>重要安全須知</b>
02	10	<b>瞭解本機</b>
	10	洗碗機各部件
	11	控制台
03	12	<b>使用洗碗機</b>
	14	洗碗機置物籃裝物操作
	18	添加洗滌劑
	20	<b>洗碗機功能設計</b>
04	20	清洗功能表
	21	開機
	21	更改程式
	22	忘記添加碗盤
	23	清洗功能結束時
	24	<b>維護與清潔</b>
05	24	過濾系統
	25	洗碗機維護
	28	<b>安裝說明</b>
06	28	安裝準備
	29	關於電源連接
	30	通水
	30	排水管連接
07	31	<b>故障排除指南</b>
	31	呼叫服務之前
	34	錯誤代碼
	35	技術資訊

# 重要安全須知

---

## 警告

**使用洗碗機時，請遵守以下注意事項：**

- 本機器用於家用和類似用途，如：
  - 商店、辦公室和其他工作環境內的員工廚房；
  - 酒店、汽車旅店和其他住宿環境內由客人自用；
- 本機器可供8歲以上兒童或缺少經驗、知識的人士使用，但在使用時應給以有關安全使用本機器的監督或指導，並使其瞭解潛在危險。兒童不得玩弄本機器。兒童未經監督，不得進行清潔和維護。（IEC60335-1）

- 本機器僅供室內、家庭使用。
- 為防止觸電，請勿將裝置、線纜或插頭浸入水中或其他液體中。
- 清潔和維護前，請拔下插頭。
- 清潔時請使用軟布，以溫和的肥皂水濕潤後再行清潔，然後使用乾布再擦拭一次。

## ⊕ 接地說明

---

- 本機器必須接地。如發生故障，接地至少可以提供一定的電阻，從而降低觸電風險。本機器配備的線材包含設備接地導線和接地插頭。
- 插頭必須插入相應的插座，插座的安裝和接地應符合當地規範和法規。
- 如插頭無法插入插座，請勿自行改裝機器自帶的插頭。應由專業電工安裝配套插座。
- 設備接地導線連接不當會導致觸電風險。如無法確定是否正確接地，請諮詢水電廠商。

## ● 一般使用

---

- 操作機門或碗盤架時，請務必遵守操作說明。
- 操作洗碗機時，務必確認所有封蓋均已關閉。
- 洗碗機運行時，開啟機門務必小心，有濺出危險。
- 機門打開時，請勿將重物放置在機門上，也不要坐在機門上。本機器可能向前傾倒。
- 放入餐具洗滌時：
  - 1) 注意尖銳物品不要放在可能劃傷機門密封件的地方；
  - 2) 警告：餐具和其他帶有尖刺的廚房用具必須放在置物籃中，尖頭朝下，或者水平放置。



- 請勿清洗塑膠物品，但如明確標示為可以用洗碗機或類似機器洗滌的，不在此列。未標示的塑膠物品，請參考該物代理商建議。
- 務必使用針對自動洗碗機設計的洗滌劑。
- 不要在洗碗機內使用肥皂、洗衣粉或手洗液。
- 應對兒童加以監督，確保其不會玩弄本機器。
- 機門不得敞開，以免絆倒。
- 如電源線損壞，應由廠商、服務代表或相關專業人員更換，避免發生危險。
- 安裝時，不得過度或以危險方式彎曲或擠壓電源線。
- 請勿重擊控制器。
- 本機器應使用新的軟管套件與主水管相連，不要重複使用老舊的軟管套件。
- 可供洗滌餐具件數：22件餐具。
- 允許進水壓力最高為1MPa。
- 允許進水壓力最低為0.04MPa。

## 處置

---

- 處置本機器及其包裝時，應交予回收中心。處置時請切斷電源線，將機門關好，使其保持在不可用的狀態。
- 硬紙板包裝以回收紙製作，應放入廢紙堆中回收。
- 確保產品的正確處置，有助於防止因產品廢物處置不當而對人類和環境健康造成有害的潛在負面後果。
- 更多關於產品回收的資訊，請聯繫當地辦事處及家庭廢物處置服務。
- 處置：請勿將本品當成未分類廢物處置。必須對廢物進行隔離收集，以供特殊處理。



# 瞭解本機

## 重要：

首次使用洗碗機之前，為達到最佳使用效果，請閱讀本說明書。

## 洗碗機各部件

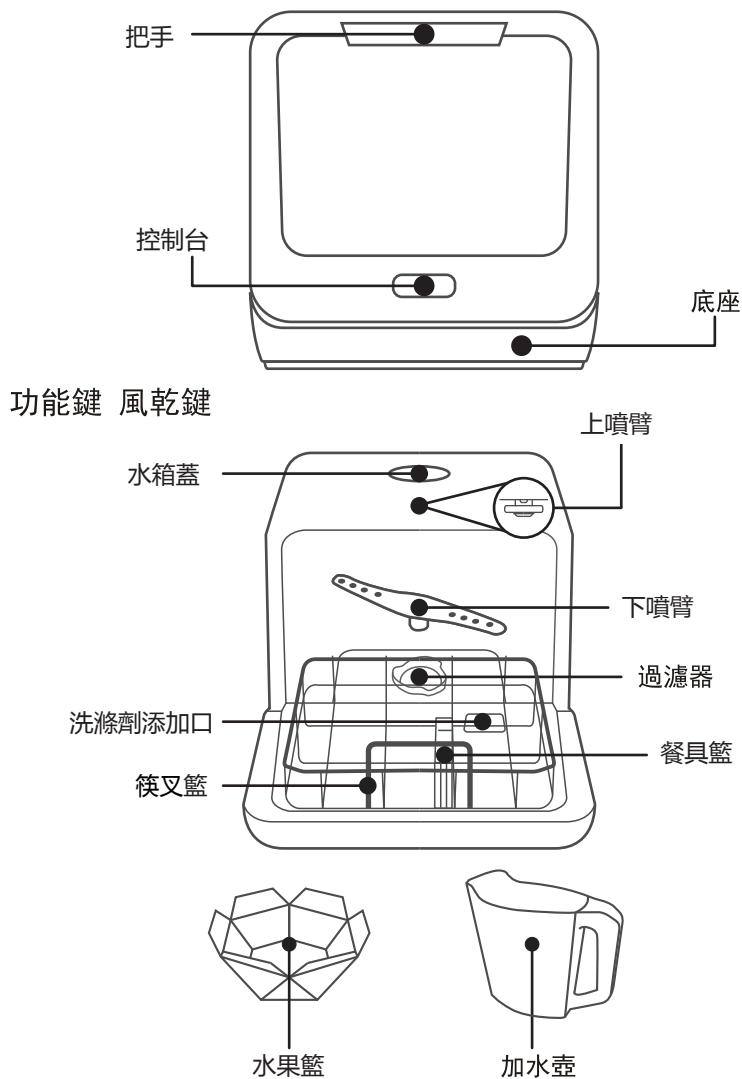

## ● 控制台

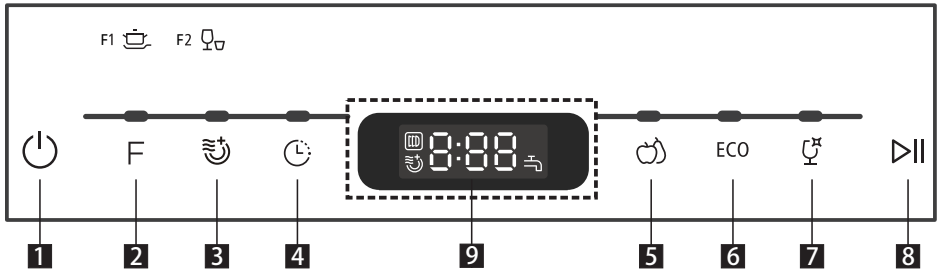

<b>1 電源鍵</b>	通電和斷電。
<b>2 功能鍵</b>	功能按鈕：按下按鈕，選擇洗滌功能 F1 (強力洗  ) -F2 (快速洗  )
<b>3 風乾鍵</b>	 保管：針對洗滌結束後，餐具還繼續保存在洗碗機內，可除味，除濕，防霉。   加強乾燥：為獲得更好乾燥效果，選擇此功能
<b>4 預約鍵</b>	顯示預約啟動時間00-24小時。
<b>5 水果洗</b>	12min：適合清洗一定大小的水果表面，比如蘋果、葡萄、棗子。 6min：適合表面脆軟的水果，比如草莓。
<b>6 環保洗</b>	此為默認功能，適合普通髒汙程度的餐具。
<b>7 玻璃洗</b>	針對輕微髒汙的餐具，如玻璃品、水晶和精細瓷器。
<b>8 啟動/暫停</b>	按下按鈕，啟動或暫停洗碗機，時鐘指示燈會閃爍。
<b>9 顯示屏</b>	顯示時間、功能等。

## ● 洗碗機置物籃裝物操作

---

### 建議

- 請考慮購買確定能使用洗碗機清洗的餐具。
- 請使用標為“適用於洗碗機”的洗滌劑。如果需要，請向洗滌劑廠商尋求更多資訊。
- 對於某些特殊物品，請盡量選擇溫度低的程式。
- 為防止損壞，洗滌模式結束後，請勿立刻將玻璃和刀叉等從洗碗機中拿出。

## 適合用於洗碗機的物品

---

### 不適合的物品：

- 帶有木製、瓷器把手的刀叉餐具
- 不耐熱的塑膠物品
- 其他帶有不耐熱塑膠部件的刀叉餐具
- 黏合的刀叉餐具或碗碟
- 鉛錫或銅制物品
- 會生鏽的鋼制物品
- 木製物品
- 合成纖維製成的物品

### 限制使用：

- 某些玻璃經大量清洗後會失去光澤。
- 銀、鋁製品清洗後可能會掉色。
- 頻繁清洗後，瓷器可能會褪色。

## 洗碗機置物籃裝載前後注意事項

---

( 為使洗碗機得到最佳效果，請遵守以下裝載說明。置物籃及筷叉籃的特點與外觀可能隨機型而發生變化。 )

倒掉大塊食物殘。將物品按如下步驟放入洗碗機：

- 杯具、玻璃品、盤等物品朝下擺放。
- 彎曲物品或帶有凹坑的物品應傾斜放入，方便沖洗。
- 所有器皿應疊放牢靠，不要傾斜。
- 所有器皿在擺放時，應保證噴臂在清洗時自由旋轉。

### ▲ 注意

微小物品容易掉出置物籃，不得放入洗碗機洗滌。

- 空心物件，如杯子、玻璃品、盤子等，應將開口朝下放置，防止容器內積水。
- 碗盤和刀叉物件必須相互疊套，或者相互覆蓋。
- 豎直朝上的較長的開刃刀具可能造成潛在危險！

- 較長和/或尖銳的刀叉物品（如切肉刀）必須水平放置在置物籃內。
- 洗碗機請勿超載。這一點對洗滌效果很重要，也是出於節能的合理必要。

## 置物籃

將餐具擺放固定好，避免隨水流移動。

為了是噴射水柱能夠清潔表面，需將髒污面放在靠內的位置。

將筷子籃底部的小孔對準碗籃定位孔，然後用力向下壓將其固定在碗籃上。

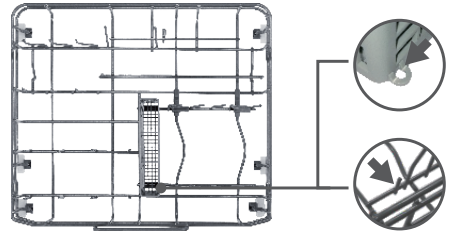

### 警告

任何器具不得從底部伸出。  
保證尖銳餐具的尖端朝下！

## 筷子及湯匙

---



高度25mm 以下。擺放刀具時小心預防刮擦。

- \* 刀具及其他尖銳器具須放入籃中，尖端朝下或平放。

## 置物籃的使用

---

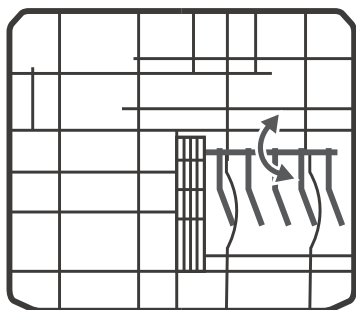

置物籃有一個可調節的活動排。  
調節活動排以達到最佳洗滌  
效果。

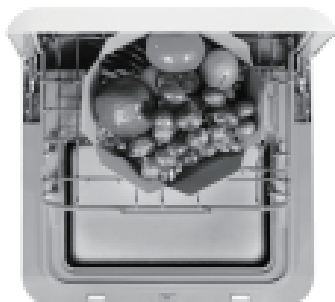

水果籃適於放置一定大小的水果



## ● 添加洗滌劑

---

### ⚠ 警告

- **務必使用洗碗機專用洗滌劑。**  
請勿使用其他清洗助劑和洗滌劑。否則可能損壞機器。

-  **洗碗機洗滌劑有腐蝕性！**  
**洗碗機洗滌劑不要放在兒童能夠拿到的地方。**

### 濃縮洗滌劑

根據化學成本，去污劑可分為兩個基本類型：

- 帶有腐蝕性成分的常規鹼性洗滌劑。
- 帶有天然酶的低鹼性濃縮洗滌劑。

正常清洗程式配合濃縮洗滌劑使用，可減少污染，對碗盤也有好處。

### 洗滌錠

不同品牌的洗滌錠的溶解速度不同。出於這個原因，在較短的清洗功能中，某些洗滌錠無法溶解並發揮出最大清潔效力。因此，在使用洗滌錠時，請選擇較長的清洗功能，確保完全清除洗滌劑殘留。

### 洗滌劑

每個清洗模式開始前，必須對照清洗功能表中給出的說明，重新添加洗滌劑。相較常規洗碗機，本品消耗的洗滌劑更少。一般來說，正常清洗量只需要一勺洗滌劑。嚴重髒汙的物品則需要更多洗滌劑。務必在啟動洗碗機之前添加洗滌劑，否則可能造成殘留和溶解不足。

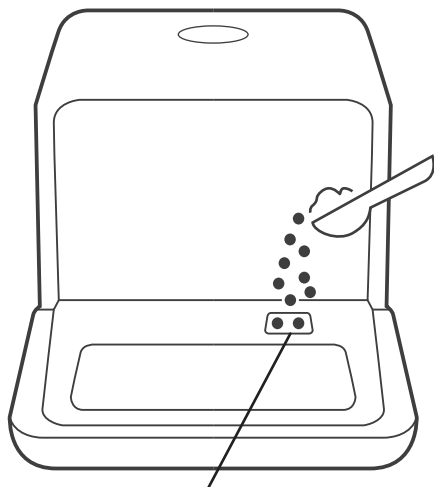

洗滌劑添加口 ( 蔬果模式不得添加洗滌劑 )



# 洗碗機功能設計

## 清洗功能表

下表顯示食物殘渣量對應的最佳功能，以及洗滌劑的需要量。

沖刷：清潔主要污漬 快速清潔。

清洗：高溫清潔剩餘殘留汙漬，深層清潔。

功能	功能選擇資訊	功能說明	洗滌劑	時間 (分鐘)	能耗 (千瓦時)	耗水 (升)
 強力洗	針對重油污餐具。	沖刷 (62°C) 清洗 (70°C) 清洗 乾燥	6 克	160	0.5	5
 快速洗	針對輕微髒污餐具的快速清洗。	沖刷 (45°C) 清洗 (55°C) 清洗	6 克	29	0.35	5
 12min	適合清洗一定大小的水果表面， 比如蘋果、葡萄、棗子。 不適合表皮脆軟的水果。	清洗 (36°C)	少許蘇打粉	12	0.15	5
 6min	適合表皮脆軟的果蔬，如草莓。	清洗	/	6	0.01	5
<b>ECO</b> (*En5 0242) 經濟洗	此為默認功能，適合普通髒污 程度的餐具。	沖刷 (55°C) 清洗 (68°C) 清洗 乾燥	6 克	155	0.45	5
 玻璃洗	針對輕微髒污的物品，如玻璃 品、水晶和精細瓷器。	沖刷 (50°C) 清洗 (65°C) 清洗 乾燥	6 克	85	0.4	5

### ⚠ 注意

**EN 50242:** 本程式為測試模式。EN 50242相容性測試資訊如下：  
關機模式耗電量為0.45W，通電模式為0.49W。

## 開機

啟動清洗模式.....

抽出置物籃（見“洗碗機裝物”一節）。

倒入洗滌劑（見“添加洗滌劑”一節）。

將插頭插入插座。電源為110V AC 60 HZ，插座規格為10 A 110V AC。

按下電源按鈕，使機器通電。

將進水管連接到水龍頭，確保供水壓力充足，或者手動往水箱加水。

根據“清洗模式表”選擇適當功能。

選擇功能後，感應燈即亮起。此時按下“啟動/暫停”按鈕，洗碗機啟動。

### ⚠ 注意

清洗時按下“啟動/重定”按鈕將會暫停，然後功能燈停止閃爍，洗碗機每分鐘都會發出聲響，直至按下“啟動/重定”按鈕啟動為止。

## 更改程式

前提條件：如果洗碗機僅運行了較短時間，可以修改清洗程式。否則，在已經放入了洗滌劑，並且機器已經排乾了洗滌水的情況下，必須重啟清洗模式。

機門關閉時，按下“啟動/暫停”按鈕，機器將會暫停。

按下“功能”按鈕超過3秒，機器將進入待機模式，此時可將程式更改為所需模式（見“啟動清洗程式”一節）。

顯示屏顯示洗碗機狀態：

- a) 顯示屏顯示 “-:-” 待機；
- b) 顯示屏顯示 “H:MM” 且不再閃爍 暫停；
- c) 顯示屏顯示 “H:MM” 且閃爍 運行；
- d) 顯示屏顯示 “END” 結束。

本機型有記憶功能，斷電後恢復通電仍會繼續運行，直至結束所選程式。

## 忘記放入碗盤

洗滌劑分液器打開之前，可隨時添加忘記放入的碗盤。此時，請遵守如下說明：

1. 按下“啟動/暫停”按鈕
2. 將機門打開一點，停止清洗。
3. 噴射臂停止運行後，可將機門完全打開。
4. 添加忘掉的碗盤。
5. 關閉機門。
6. 按下“啟動/暫停”按鈕，洗碗機將開始運行。

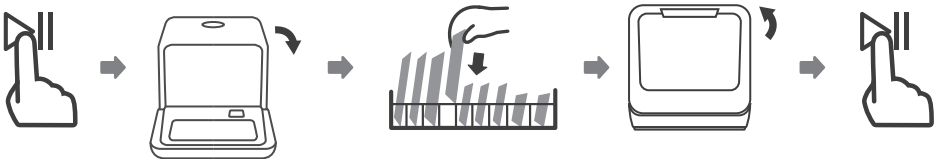

## ● 清洗功能結束時

---

運行功能結束時，洗碗機蜂鳴器將持續鳴響8秒，然後停止。使用“ON/OFF”按鈕關閉機器，斷掉電源，然後打開洗碗機的機門。從洗碗機中拿出物品時，應先等待幾分鐘，避免燙傷，因為此時碗盤和器皿仍然很燙，而且容易破裂，這樣也可以使其更好地乾燥。

- 關閉洗碗機

1. 按下“ON/OFF”按鈕，關閉洗碗機。
2. 關閉水龍頭！

- 小心開啟機門

滾燙的碗盤容易碰碎。碗盤在從機器中拿出來之前，應先冷卻約15分鐘。

打開洗碗機的機門半開，等待幾分鐘，然後將碗盤拿出來。這樣一來，碗盤就會更加冷卻，乾燥效果得到提高。

- 洗碗機取出餐具碗盤

洗碗機內部正常情況下是潮濕的。

 **警告**

清洗時打開機門十分危險，因為可能被熱水燙傷。

# 維護與清潔

## 過濾系統

### 警告

- 無過濾系統不得使用洗碗機！
- 請確認過濾系統已正確組裝。  
否則洗滌效果會受到影響，碗盤和器皿也會損壞。

過濾網能有效地清除洗滌水中的食物殘渣，使其在過程中可以回收。

為得到更好的效果，應定時清潔過濾系統。

因此，清洗功能結束後，可用清水洗滌過濾網和提杯，以清理過濾網內的大塊食物殘渣。

清洗過濾系統時，應將提杯把手朝上。

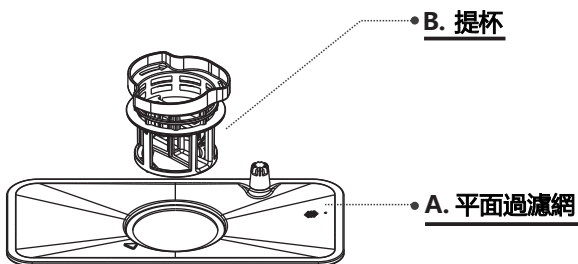

步驟1：反向旋轉提杯，然後將其拉起。



步驟2：從A中拉起B。

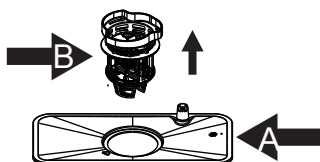

### ▲ 注意

從步驟1到步驟2，將卸載過濾系統；如果從步驟2到步驟1，則為安裝過濾網。  
整個過濾系統應每週清潔一次。

- 每次使用洗碗機後，應檢查過濾網是否堵塞。
- 拆下提杯後，可將過濾系統拆除。清理食物殘渣，然後在流水下清潔過濾網。

### ▲ 警告

清潔過濾網時，不要碰撞。否則，過濾網可能會扭曲，從而降低洗碗機的清洗效果。

## ● 洗碗機維護

---

控制台可用濕布清潔。清潔後，務必徹底乾燥。不要用尖銳物體、鋼絲球或粗糙的清潔用具處理洗碗機任何部件。

### 清潔機門

清潔機門邊緣時，應使用柔軟濕布。

為避免水滲入門鎖和電氣件，請勿使用任何類型的高壓清潔器具。



## 清潔噴臂

噴臂可輕鬆卸下，方便定期清潔噴嘴，防止堵塞。請在流水下清潔，並小心放入底座，檢查旋轉動作是否受阻。

握住噴臂中部，往上提拉，將其卸下。用流水沖洗噴臂，然後小心放入底座。重新安裝後，檢查噴臂能否自由旋轉。如果不能，請檢查是否正確安裝。

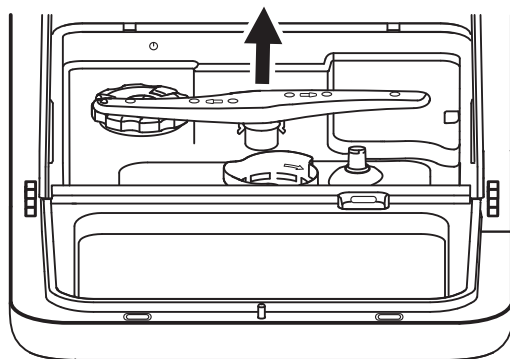

## ● 如何保持洗碗機的良好狀態

---

### 每次清洗後

每次清洗後，關閉水源，把機門打開，使濕氣和味道逸出。

### 拔掉插頭

清潔或維護前，務必將插頭從插座上拔出。

### 不要使用溶劑和銳利堅硬物品

清潔洗碗機外部和橡膠部件時，不要使用溶劑或銳利堅硬物品清洗產品。只能使用沾有溫熱肥皂水的布料。

清理外表面斑點時，請使用沾有水和醋的布塊，或洗碗機專用的清潔產品。

### 長時間不用

建議讓洗碗機在某個清洗功能下空轉後，然後拔掉插頭，關閉水源，把機門打開，以便通風。這樣可以延長機門密封件的壽命，防止氣味積留在機器內部。

### 移動機器

必須移動機器時，請儘量保持垂直狀態。如果確實必要，可將機器背部朝下放置。

# 安裝說明

---

## 警告



### 觸電危險

安裝洗碗機之前請斷開電源。  
否則會導致觸電甚至死亡。

## 安裝準備

---

洗碗機的安裝位置應靠近進水龍頭和排水口電源插座。

## 機器位置

---

將機器放在預定位置。背部靠牆，兩側沿相鄰櫥櫃或牆壁放置。洗碗機配備供水和排水管，可分置左右，方便安裝。

## 關於電源連接

### 警告

個人安全：

- 本機請勿使用延長線或適配插頭。
- 任何情況下，請勿從電源線上切斷或移除接地連接。

### 電氣要求

請檢查額定標籤，瞭解額定電壓，將洗碗機與相應電源連接。按要求使用推薦的10安培保險絲、延時保險絲或斷路器，並為本機安排單獨的電路。

### 電氣連接

確定電壓和電源頻率與銘牌相符。插頭務必插入接地良好的插座中。如果機器插座與插頭不相配，會導致過熱和燃燒，請務必更換插座。

▲ 使用前確定接地良好

## 接水

將冷水管與螺紋連接器（3/4英寸）連接，確定緊固到位。

如為新水管或長時間不用的水管，請先放水，確定水質清潔、無異物。否則進水管可能堵塞或損壞機器。

注意：如果提供的水管與水龍頭不相配，請聯繫當地水電材料行購買轉接頭。

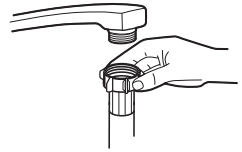

## ● 排水管連接

---

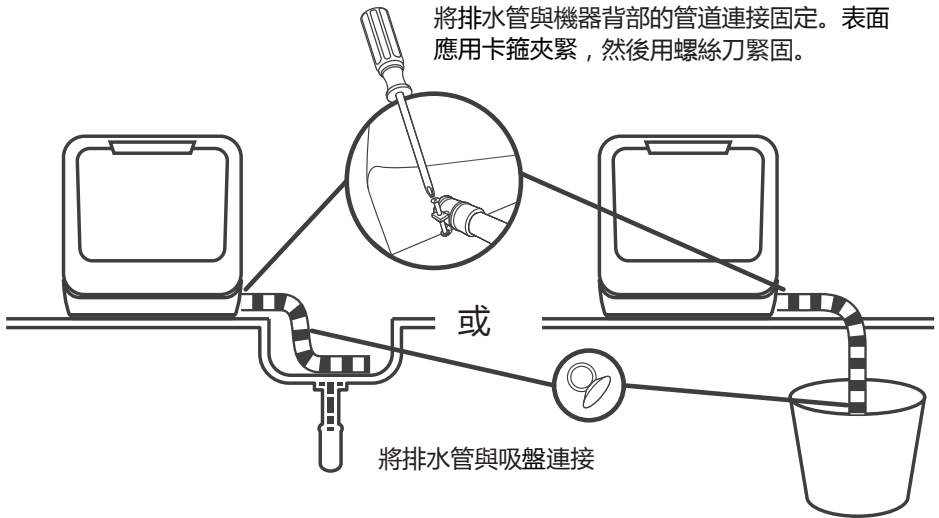

排水管連接：將排水管末端放入水槽或水桶。

### 如何將水管中多餘的水排出

如果水槽離地超過1000mm，水管中多餘的水就無法從水槽中直接排出。必須將水管中多餘的水排入外部低於水槽的容器中。

### 排水管

接上排水管。排水管必須正確連接，避免漏水。請勿彎曲或擠壓排水管。

### 延長管

如果需要延長排水管，務必使用相似的排水管。延長線不得超過4米，否則會降低洗碗機的清洗效果。

# 故障排除指南

## 呼叫服務之前

請查看下文中的圖表，這樣可以先行做初步的故障排除。

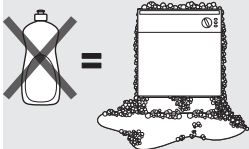
問題	可能原因	如何解決
洗碗機無法啟動	保險絲斷裂，或電源跳開。	更換保險絲或重置電源。移除與洗碗機共用同一線路的其他電器。
	電源未開啟。	確定洗碗機已通電且機門緊閉。 確定電源線正確插入牆壁插座。
	錯誤代碼：E1 水壓較低。	檢查供水連接是否正確，是否有水。
	洗碗機門是否正確關閉。	確定機門正確關閉，然後上鎖。
洗碗機無法排水	排水管扭曲。	檢查排水管。
	過濾系統堵塞。	檢查粗孔篩檢程式。
	廚房水槽堵塞。	檢查廚房水槽，確定排水良好。 如果廚房水槽無法排水，需要聯繫水電廠商，而不是洗碗機維修廠商。
機體內有泡沫	洗碗粉使用不正確 洗碗粉過期或發霉 	為了避免泡沫的產生，請使用洗碗機專用的洗碗粉。如果發生這種情況，請打開洗碗機門放置20~30分鐘讓泡沫揮發掉。若內膽還有泡沫，可在內膽添加1.5升水，關上洗碗機門，運行強排操作將水排出，反復進行以上操作，直到泡沫清除為止。使用有效期以內的洗碗粉

問題	可能原因	如何解決
	清洗劑濺出	務必立刻清理濺出的清洗劑。
內膽內部有斑點	使用了帶有著色的洗滌劑	確定洗滌劑不含著色劑。
內表面白色結膜	硬水礦物	清理內部時，請使用沾有洗碗機洗滌劑的濕潤海綿，並戴上橡膠手套。 請勿使用其他非洗碗機專用的清潔劑，以免產生泡沫。
刀叉有鏽斑	受影響物品不耐腐蝕。	避免在洗碗機中清洗不耐腐蝕的物品。
清洗有撞擊聲	噴臂碰撞了置物籃中的物品。	中斷清洗，重新擺放阻礙噴臂的物品。
清洗櫃有異響	器皿鬆動。	中斷清洗，重新擺放器皿。
水管有沖擊聲	這可能是現場安裝或水管連接導致的。	對洗碗機功能沒有影響。 如有疑問，請聯繫專業管道工人。
碗盤不乾淨	碗盤未正確放置。	見“洗碗機置物籃裝載前後注意事項”一節。
	功能不適當。	選擇更適合的功能。

問題	可能原因	如何解決
碗盤不乾淨	洗滌劑分配不足。	請使用更多的洗滌劑，或更換洗滌劑。
	物品阻擋了噴臂。	重新擺放物品，使噴臂自由旋轉。
	清洗櫃底座上的過濾系統不乾淨，或未正確安裝。 這會導致噴臂孔堵塞。	請正確清潔和/或安裝過濾系統。 清潔噴射臂孔。
玻璃器皿表面有殘留	水質太硬，洗滌劑過多。	如果使用了軟水，應減少洗滌劑用量，然後選擇較短的清洗模式清潔玻璃器皿。
碗盤和杯具有白色斑點	硬水會造成水垢沉積。	使用檸檬酸或含有軟化鹽的洗滌劑。
碗盤無法乾燥	擺放不當。	按建議往洗碗機內擺放至正確位置。
	過早拿出碗盤。	請勿清洗後立刻拿出碗盤。請將機門打開，使蒸汽逸出。待內部溫度降低到安全溫度後，再拿出碗盤。
	選擇功能錯誤	時間較短時，清洗溫度較低，降低了清潔效果。 請選擇清洗時間較長的功能。
	使用了塗層品質較低的刀叉	這些物品會使排水變得更困難。 這種類型的刀叉或碗盤不適合洗碗機清洗。



## 錯誤代碼

出現故障時，機器將顯示如下提示代碼：

代碼	含義	可能原因
E1	進水時間過長。	流量計或排水泵故障，應由授權廠商修理。
E3	未達到所要求的溫度	加熱管或熱敏電阻異常，應由授權廠商修理。
E4	漏水	洗碗機某些元件漏水。
E9	觸摸按鍵失靈	水或其他物質導致E9 應由授權廠商修理。
Ed	通信故障	應由授權廠商修理。
EF	水箱浮子異常	應由授權廠商修理。



### 警告

- 如果發生漏水，請關閉主水源，然後呼叫維修服務。
- 如果水量過滿或底盤中有水，請在開啟洗碗機之前清理積水。

## • 技術資訊

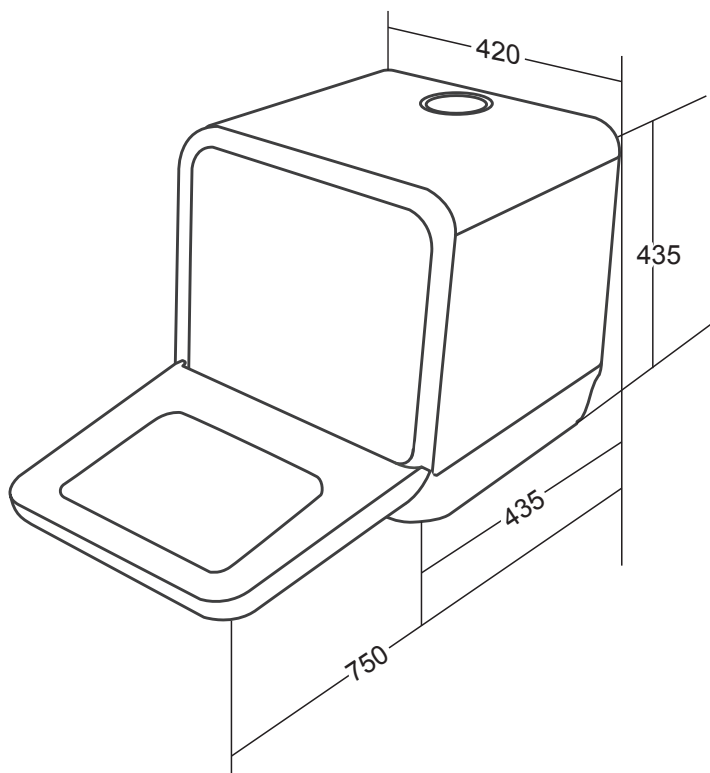

高度	435mm
寬度	420mm
深度	435mm
電壓連接載荷	見額定標籤
水壓	0.04 - 1.0MPa
電源	見額定標籤
容量	22件餐具設定

名稱：洗碗機

型號（型式）：HAMDWQP42601SA PC

單元	限用物質及其化學符號					
	鉛 (Pb)	汞 (Hg)	鎘 (Cd)	六價鉻 (Cr <sup>+6</sup> )	多溴聯苯 (PBB)	多溴二苯醚 (PBDE)
外門	○	○	○	○	○	○
把手	○	○	○	○	○	○
導線	○	○	○	○	○	○
外殼	○	○	○	○	○	○
內門	○	○	○	○	○	○
呼吸器	○	○	○	○	○	○
內膽	○	○	○	○	○	○
開關	○	○	○	○	○	○
底座	○	○	○	○	○	○
噴臂組件	○	○	○	○	○	○
頂板組件	○	○	○	○	○	○
水杯	○	○	○	○	○	○
碗籃	○	○	○	○	○	○
水管	○	○	○	○	○	○
螺釘	○	○	○	○	○	○
洗滌泵	○	○	○	○	○	○
加熱管	○	○	○	○	○	○
電路板	超出 0.1 wt %	○	超出 0.01 wt %	○	○	○
電源線	超出 0.1 wt %	○	○	○	○	○

備考1. “超出0.1 wt %”及“超出0.01 wt %”係指限用物質之百分比含量超出百分比含量基準值。

備考2. “○”係指該項限用物質之百分比含量未超出百分比含量基準值。

備考3. “—”係指該項限用物質為排除項目。



台灣美芝消費電器股份有限公司  
105 台北市松山區健康路152號3樓  
電話：27600066  
傳真：27660123  
統一編號：85023882

**HAMDWQP42601SA PC**

# **DISHWASHER**

Instruction Manual

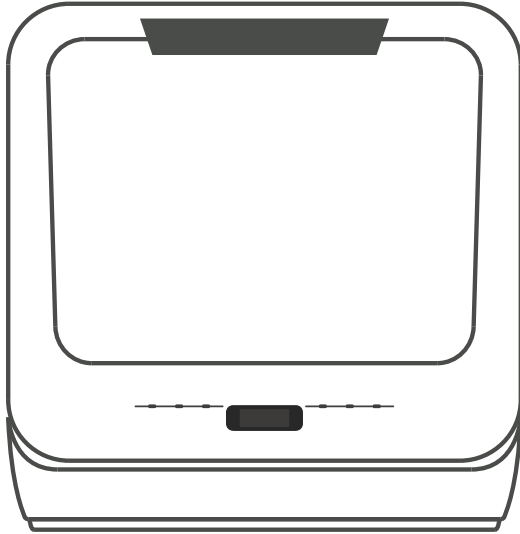

# QUICK USER GUIDE

Please read the corresponding content on the instruction manual for detailed operating method.

## Connected to power supplies

The power supply is 110 V AC 60 Hz  
the specification of the socket is 10 A 110 V AC

The connection of the drain pipe: Put end of the drain into a sink or bucket.

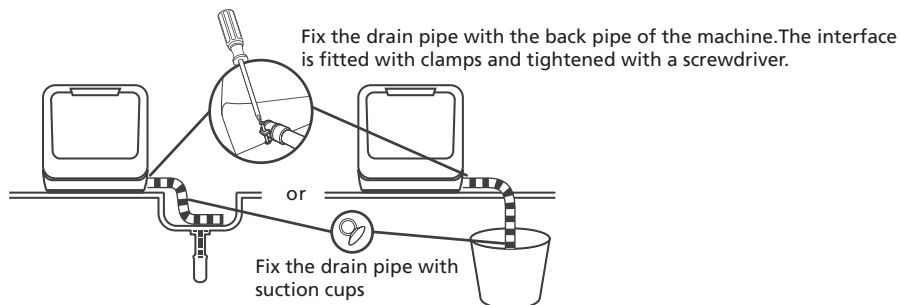

## Remove the larger residue

Please remove the large residue before placing.



## Open the door, placing the dishes and adding detergent

Placing order by size and from the two sides to the middle. All cutlery are suggested to be tilted to improve cleaning performance.

The arm will be blocked with the improper placement of the cutlery and cleaning effect may not be ideal.

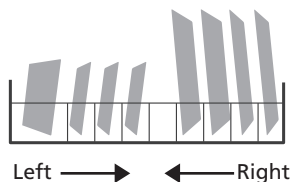
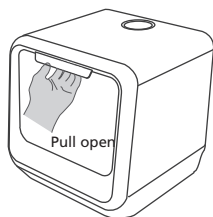

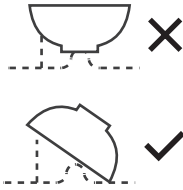

Should not place the cutlery in the right direction or may affect the cleaning performance. Try to leave the dirty face towards the spray arm.

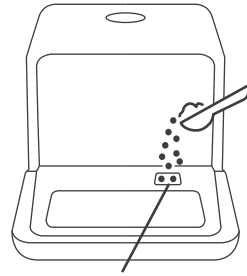

The palate to add the detergent  
(The program of fruit should not add the detergent)

## Add water into the dishwasher's tank

There are two ways to add water into the tank:

- 1 Connect inlet hose to the tap;
- 2 Open the cap and add water into the dishwasher's tank manually

There are two ways of prompting the tank that full of water.

### 1. Before starting:

When the tank is full of water, the machine will drip-drip-drip-drip-drip beeps.

### 2. After starting :

Water is not enough,  lights on;

Water is enough,  lights is not on and the machine will drip-drip-drip-drip-drip beeps.

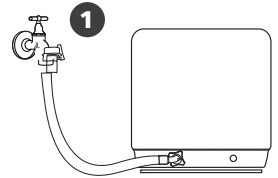

or

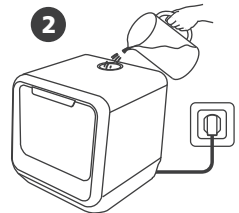

## Close the door, select the program and start the dishwasher

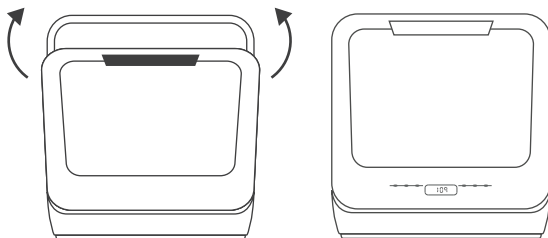

# CONTENTS

Please carefully read this manual before using the dishwasher, it will help you use and maintain the dishwasher properly .

01	5	<b>IMPORTANT SAFETY INSTRUCTIONS</b>
02	10	<b>GETTING TO KNOW YOUR APPLIANCE</b>
	10	Dishwasher features
	11	Control panel
03	12	<b>USING YOUR DISHWASHER</b>
	12	Loading the salt into the softener
	13	Adjusting Salt Consumption
	14	Loading the dishwasher baskets
	18	Filling the dispenser
04	20	<b>PROGRAMMING THE DISHWASHER</b>
	20	Wash cycle table
	21	Turning on the appliance
	21	Change the programme
	22	Forget to add a dish?
	23	At the end of the wash cycle
05	24	<b>MAINTENANCE AND CLEANING</b>
	24	Filter system
	25	Caring for the dishwasher
06	28	<b>INSTALLATION INSTRUCTION</b>
	28	Installation preparationnce
	29	About Power Connection
	30	Water Connection
07	30	Connection of drain hoses
	31	<b>TROUBLESHOOTING TIPS</b>
	31	Before calling for service
	34	Error codes
	35	Technical information



# IMPORTANT SAFETY INSTRUCTIONS

---

## **⚠ WARNING**

**When using your dishwasher , follow the precautions listed below:**

- This appliance is intended to be used in household and similar applications such as:
  - staff kitchen areas in shops, offices and other working environments;
  - farm houses;
  - by clients in hotels, motels and other residential type environments;
  - bed and breakfast type environments.
- This appliance can be used by children aged from 8 years and above and persons with reduced physical, sensory or mental capabilities or lack of experience and knowledge if they have been given supervision or instruction concerning use of the appliance in a safe way and understand the hazards involved. Children shall not play with the appliance. Cleaning and user maintenance shall not be made by children without supervision.(For EN60335-1)
- This appliance is not intended for use by persons(including children )with reduced physical, sensory or mental capabilities, or lack of

experience and knowledge, unless they have been given supervision or instruction concerning use of the

- appliance by a person responsible for their safety.

(For IEC60335-1)

- This appliance is for indoor use only, for household use only.

To protect against the risk of electrical shock, do not

- immerse the unit, cord or plug in water or other liquid.
- Please unplug before cleaning and maintaining the appliance .

Use a soft cloth moisten with mild soap, and then use a dry cloth to wipe it again.

## • **Earthing instructions**

---

- This appliance must be earthed. In the event of a malfunction or breakdown, earthing will reduce the risk of an electric shock by providing a path of least resistance of electric current. This appliance is equipped with a cord having an equipment-earthing conductor and a earthing plug.
- The plug must be plugged into an appropriate outlet that is installed and earthed in accordance with all local codes and ordinances.

- Do not modify the plug provided with the appliance; If it does not fit the outlet. Have a proper outlet installed by a qualified electrician.
- Improper connection of the equipment-earthing conductor can result in the risk of an electric shock. Check with a qualified electrician or service representative if you are in doubt whether the appliance is properly earthed.

## **General use**

---

- Do not abuse, sit on, or stand on the door or dish rack of the dishwasher.
- Do not operate your dishwasher unless all enclosure panels are properly in place.
- Open the door very carefully if the dishwasher is operating, there is a risk of water squirting out.
- Do not place any heavy objects on or stand on the door when it is open. The appliance could tip forward.
- When loading items to be washed:
  - 1) Locate sharp items so that they are not likely to damage the door seal;
  - 2) **Warning:** Knives and other utensils with sharp points must be loaded in the basket with their points down or placed in a horizontal position.
- Check that the detergent powder is empty after completion of the wash cycle.

- Do not wash plastic items unless they are marked dishwasher safe or the equivalent. For plastic items without mark, check the manufacturer's recommendations.
- Use only detergent additives designed for an automatic dishwasher.
- Never use soap, laundry detergent, or hand washing detergent in your dishwasher.
- Children should be supervised to ensure that they do not play with the appliance.
- The door should not be left open, since this could increase the risk of tripping.
- If the supply cord is damaged, it must be replaced by the manufacturer or its service agent or a similarly qualified person in order to avoid a hazard.
- During installation, the power supply must not be excessively or dangerously bent or flattened.
- Do not tamper with controls.
- The appliance is to be connected to the water mains using new hose sets and that old hose-sets should not be reused.
- The maximum number of pieces to be washed is 22.
- The maximum permissible inlet water pressure is 1MPa.
- The minimum permissible inlet water pressure is 0.04MPa.

## Disposal

---

- For disposing of package and the appliance please go to a recycling centre. Therefore cut off the power supply cable and make the door closing device unusable.



- Cardboard packaging is manufactured from recycled paper and should be disposed in the waste paper collection for recycling.

- By ensuring this product is disposed of correctly, you will help prevent potential negative consequences for the environment and human health, which could otherwise be caused by inappropriate waste handling of this product.

- For more detailed information about recycling of this product, please contact your local city office and your household waste disposal service.

**DISPOSAL:** Do not dispose this product as unsorted municipal waste. Collection of such waste separately for special treatment is necessary.

# GETTING TO KNOW YOUR APPLIANCE

**IMPORTANT:**



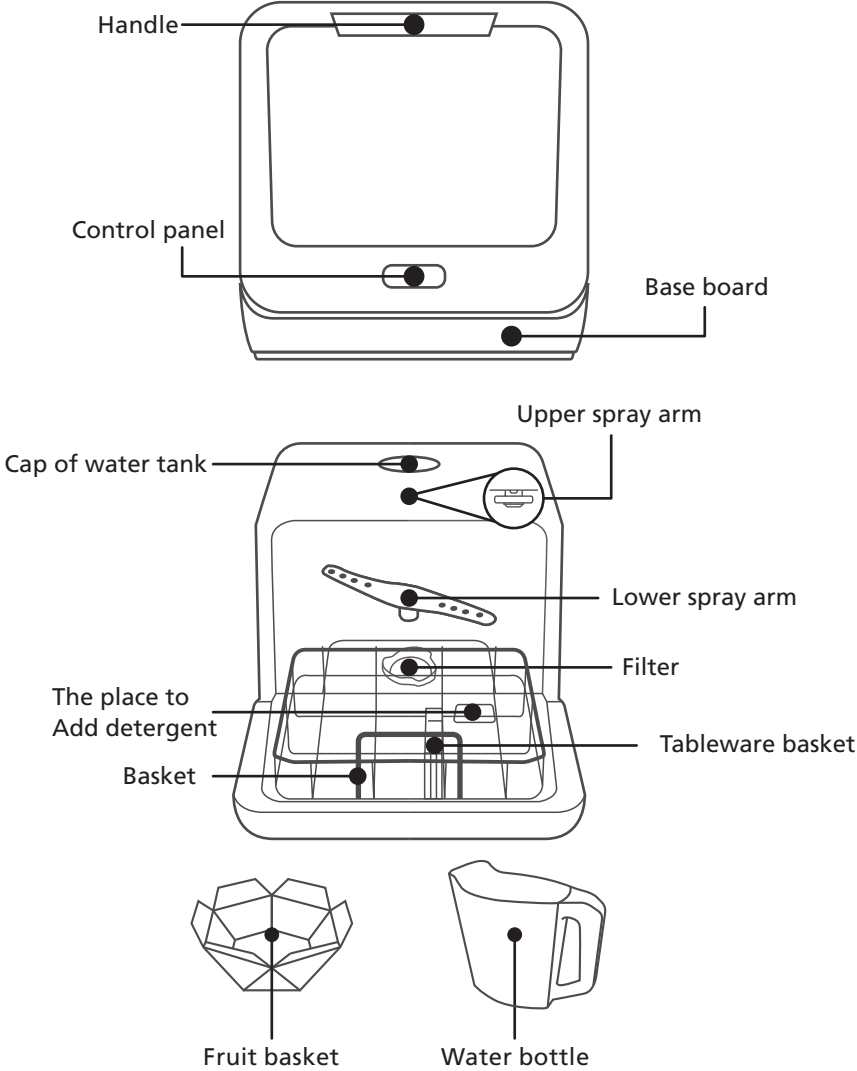

Before using this dishwasher for the first time and to get the best performance, read these instructions.

## Dishwasher features

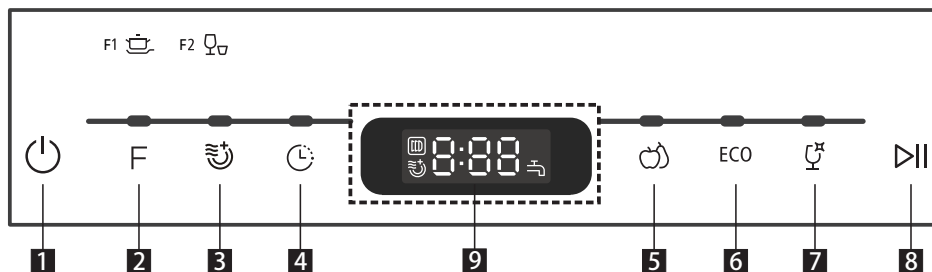

## Control panel



<b>1 Power</b>	To turn on and off.
<b>2 Program</b>	Program Button: Press the button to select wash cycles P1(Intensive  ) -P2 (Rapid  ).
<b>3 Function</b>	<p> <b>Storage</b> Get rid of the smell, damp and mildew proofing.</p> <p> <b>Extra dry</b> To select the extra dry function.</p>
<b>4 Delay</b>	To show the delay time 00~24h.
<b>5 Fruit wash</b>	Hot water : Suitable for washing fruit surfaces of a certain size, such as apple, grape, jujube. Cold water : Suitable for fruits with a weak surface, such as strawberries.
<b>6 ECO</b>	This is standard programme, it is suitable to clean normally soiled tableware and it is the most efficient programme in terms of its combined energy and water consumption for that type of tableware.
<b>7 Glass</b>	For lightly soiled loads, such as glasses, crystal and fine china.
<b>8 Start/Pause</b>	Press this button to start or pause the dishwasher, the process pilot lamp will be blinking when starting.
<b>9 Display</b>	Display the time, function and so on.

## • **Loading the dishwasher baskets**

---

### Recommendation

- Consider buying utensils which are identified as dishwasher-proof.
- Use a mild detergent that is described as 'kind to dishes'. If necessary, seek further information from detergent manufacturers.
- For particular items, select a program with as low temperature as possible.
- To prevent damage, do not take glass and cutlery out of the dishwasher immediately after the program has ended.



## Suitability of use in the dishwasher

### **Not suitable for use:**

- Cutlery with wooden, horn, china or mother-of-pearl handles
- Plastic items that are not heat resistant
- Older cutlery with glued parts that are not temperature resistant
- Bonded cutlery items or dishes
- Pewter or copper items
- Crystal glass
- Steel items subject to rusting
- Wooden items
- Items made from synthetic fibres

### **Limited suitability:**

- Some glasses can become dull after a large number of washes.
- Silver and aluminium have a tendency to discolour during washing.
- Glazed patterns may fade if washed frequently.

## Attention before or after loading the dishwasher baskets

(For the best performance of the dishwasher, follow these loading guidelines.

Features and appearance of baskets and cutlery baskets may vary from your model.)

Scrape off any large food particles. Soften remnants of burnt food in pans. It is not necessary to rinse the dishes under running water. Place objects in the dishwasher in following way:

- Items such as cups, glasses, pots/pans, etc. are face downwards.
- Curved items, or those with recesses, should be loaded at an angle so that water can run off.
- All utensils are stacked securely and can not tip over.
- All utensils are placed in the way that the spray arms can rotate freely during washing.

### **NOTE**

Very small items should not be washed in the dishwasher as they could easily fall out of the basket.

- Load hollow items such as cups, glasses, pans etc. with the opening facing downwards so that water cannot collect in the container or a deep base.
- Dishes and items of cutlery must not lie inside one another, or cover each other.
- To avoid damage to glasses, they must not be touched.
- Long bladed knives stored in an upright position are a potential hazard!

- Long and/or sharp items of cutlery such as carving knives must be positioned horizontally in the basket.
- Please do not overload your dishwasher. This is important for good results and for reasonable energy consumption.

## Loading basket

Position the dishes and cookware so that they will not get moved by the spray of water.

In order to clean the surface of the spray water column, it is necessary to place the stain on the inside.

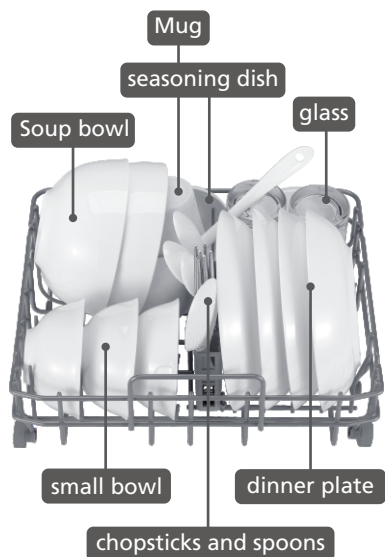

Place the small holes at the bottom of the chopsticks basket with the bowl basket, then press it hardly to fix it on the bowl basket.

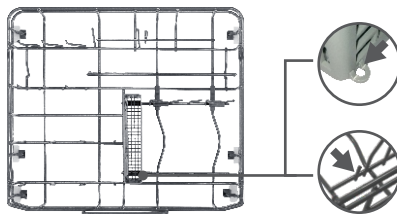

### **⚠ WARNING**

**Do not let any item extend through the bottom.  
Always load sharp utensils with the sharp point down!**

## Chopsticks and spoons



Height should be below 25cm. Handle the tableware downward. Please be careful to scratch when place sharp cutlery.

\* Knives and other sharp appliances must be packed in baskets and pointed down or horizontally placed.

## How to use the basket

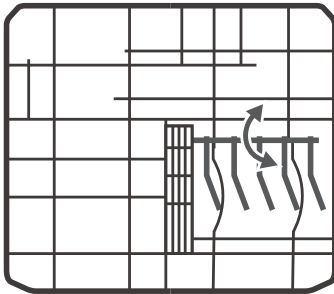

The bowl basket has an adjustable movable row. Adjust the adjustable row to achieve the best washing effect.



The fruit basket is suitable for loading a certain size surface of fruit, such as apple, grape, jujube. Not suitable for fruits with fragile surface, such as strawberries.

## • Filling the dispenser

---

The rinse aid is released during the final rinse to prevent water from forming droplets on your dishes and utensils, which can leave spots and streaks.

### **⚠ WARNING**

- **Only use detergent specifically for dishwashers.**  
Never use any other rinse aid and detergents. This will damage the appliance.
-  **Dishwasher detergent is corrosive! Keep dishwasher detergent out of the reach of children.**

## Concentrated Detergent

Based on their chemical composition, detergents can be split in two basic types:

- Conventional, alkaline detergents with caustic components.
- Low alkaline concentrated detergents with natural enzymes.

The use of Normal washing program in combination with concentrated detergent reduces pollution and is good for your dishes.

## Detergent Tablets

Detergent tablets of different brands dissolve at different speeds. For this reason some detergent tablets cannot dissolve and develop their full cleaning power during short Programs. Therefore please use long programs when using detergent tablets, to ensure the complete removal of detergent residuals.

## Detergent

The detergent must be refilled before the start of each wash cycle following the instructions provided in the Wash Cycle Table. Your dishwasher uses less detergent than conventional dishwasher. Generally, only one tablespoon of detergent is needed for a normal wash load. More heavily soiled items need more detergent. Always add the detergent just before starting the dishwasher, otherwise it could get damp and will not dissolve properly.

## Adding detergent

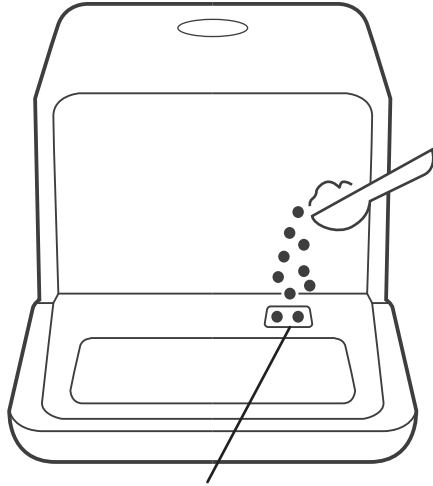





The palce to add the detergent  
(The program of friut should not add the detergent)

# PROGRAMMING THE DISHWASHER

## Wash cycle table

The table below shows which programmes are best for the levels of food residue on them and how much detergent is needed. It also show various information about the programmes.

Program	Cycle Selection Information	Description Of Cycle	Detergent	Time (min)	Energy (Kwh)	Water (L)
 <b>Intensive</b>	For lightly soiled loads that do not need excellent drying efficiency.	Wash(62 °C) Rinse Rinse(70 °C) Drying	6 g.	160	0.5	5
 <b>Rapid</b>	A shorter wash for lightly soiled loads and quick wash.	Wash (45 °C) Rinse Rinse (55°C)	6 g.	29	0.35	5
 <b>12min</b>	Suitable for washing fruit surfaces of a certain size, such as apple, grape, jujube. Not suitable for fruits with a weak surface	Wash (36°C) Rinse	A little soda powder	12	0.15	5
 <b>6min</b>	suitable for fruits with a weak surface, such as strawberries	Rinse	/	6	0.01	5
<b>ECO</b> (*En5 0242)	This is standard programme, it is suitable to clean normally soiled tableware and it is the most efficient programme in terms of its combined energy and water consumption for that type of tableware.	Wash (55 °C) Rinse Rinse (68 °C) Drying	6 g.	155	0.45	5
 <b>Glass</b>	For lightly soiled loads, such as glasses, crystal and fine china	Wash(50 °C) Rinse Rinse(65 °C) Drying	6 g.	85	0.4	5

**⚠ NOTE**

**EN 50242:** This program is the test cycle. The information for comparability test in accordance with EN 50242, are as follows:  
The power consumption of off-mode is 0.45W,  
left-on mode is 0.49W

## • **Turning on the appliance**

---

Starting a wash cycle...

Draw out the basket(see the section entitled "Loading the Dishwasher").

Pour in the detergent (see the section "Fill the detergent").

Insert the plug into the socket. The power supply is 110 V AC 60 HZ, the specification of the socket is 10 A 110 V AC.

Press the power button to turn on the appliance,

Connect the inlet hose to the tap, make sure that the water supply is turned on to full pressure, or add water the the tank manually.

select a suitable program according to the "Wash cycle table";

If a program is selected, the response light will light. Then press the Start/ Pause button, the dishwasher begins to start.

**⚠ NOTE**

When you press the Start/Reset button to pause during washing, the program light will stop blinking and the dishwasher will mooring every minute unless you press the Start/Reset button to start.

## • **Change the programme**

---

Premise: You can modify the washing program, If the dishwasher just worked for a short time. Otherwise, the detergent may have already been released, and the appliance may have already drained the wash water in this case, the cycle must be restarted.

Press Start/Pause Button to pause the machine when the door is closed ,  
Press Function Button more than three seconds the machine will be in stand by  
state , then you can change the program to the desired cycle setting  
(see the section entitled " Starting a wash program" ).

The Display window shows the state of the dishwasher:

- a) Display window shows "-:--" -----> stand by;
- b) Display window shows "H:MM" and not blinking -----> pause;
- c) Display window shows "H:MM" and blinking -----> run;
- d) Display window shows "END" -----> end.

**⚠ NOTE**

If you open the door during washing, the machine will pause. When you and press the Start/Pause Button, the machine will keep on working after 10 seconds.

If your model has broken remember function, the machine will go on to finish the selected program after the power cut.

## • Forget to add a dish

A forgotten dish can be added any time before the detergent dispenser opens. If this is the case, follow the instructions below:

1. Press the Start/Pause button
2. Open the door a little to stop the washing.
3. After the spray arms stop working, you can open the door completely.
4. Add forgotten dishes.
5. Close the door.
6. Press the Start/Pause button, the dishwasher will run .





## • **At the end of the Wash Cycle**

---

When the working cycle has finished, the buzzer of dishwasher will sound 8 seconds, then stop. Turn off the appliance using the ON/OFF button, shut off the water supply and open the door of the dishwasher. Wait a few minutes before unloading the dishwasher to avoid scald, the dishes and utensils are still hot and more susceptible to breakage. They will also dry better.

- **Switch Off the Dishwasher**

1. Switch off the dishwasher by pressing the ON/OFF button.
2. Turn off the water tap!

- **Open the door carefully**

Hot dishes are sensitive to knocks. The dishes should be allowed to cool down around 15 minutes before removing from the appliance.

Open the dishwasher's door, leave it ajar and wait a few minutes before removing the dishes. In this way they will be cooler and the drying will be improved.

- **Unloading the dishwasher**

It is normal that the dishwasher is wet inside.

 **WARNING**

It is dangerous to open the door when washing, because the hot water may scald you.

# MAINTENANCE AND CLEANING

## Filter system

### ⚠ WARNING

- **Never use the dishwasher without filters!**
- **Make sure the filter is properly assembled.**

The performance may be affected and dishes and utensils could become damaged.

The filter efficiently removes food particles from the wash water, allowing it to be recycled during the cycle.

For best performance and results, the filter assembly must be cleaned regularly. For this reason, it is a good idea to move the larger food particles trapping in the filter after each wash cycle by rinsing the filter and cup under running water. To remove the filter assembly, pull the cup handle in the upward direction.

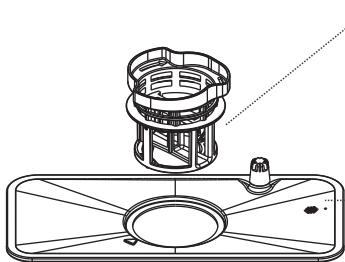

### • B. Fine filter

This filter holds soil and food residues in the sump area and prevents it from being deposited on the dishes during wash cycle.

### • A. Main filter

Food and soil particles trapped in this filter are pulverized by a special jet on the lower spray arm and washed down to drain.

Step 1: Contrarotate the filter assembly, then lift it all up.

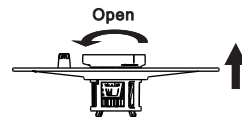

Step 2: Lift B up from A.

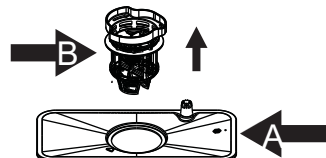

**⚠ NOTE**

If do it from step1 to step 2, the filter system will be removed; while if do it from Step 2 to Step 1, the filter system will be installed.  
The entire filter assembly should be cleaned once a week.

- Inspect the filters for blocking after every time the dishwasher has been used.
- By unscrewing the coarse filter, you can remove the filter system. Remove any food remnants and clean the filters under running water.

**⚠ WARNING**

When cleaning the filters, don't knock on them. Otherwise, the filters could be contorted and the performance of dishwasher could be decreased.

## • **Caring for the Dishwasher**

---

The control panel can be cleaned by using a lightly dampened cloth. After cleaning, make sure to dry it thoroughly. For the exterior use a good appliance polish wax. Never use sharp objects, scouring pads or harsh cleaners on any part of the dishwasher.

### Cleaning The Door

To clean the edge around the door, you should use only a soft warm, damp cloth. To avoid penetration of water into the door lock and electrical components, do not use a spray cleaner of any kind.

**⚠ WARNING**

- Never use a spray cleaner to clean the door panel as it may damage the door lock and electrical components.
- Abrasive agents or some paper towel should not be used because of the risk of scratching or leaving spots on the stainless steel surface.

## Protect against freezing

please take frost protection measures on the dishwasher in winter. Each time after washing cycles, please operate as follows.

1. Cut off electrical power to the dishwasher.
2. Turn off the water supply and disconnect the water inlet pipe from the water valve.
3. Drain water from the inlet pipe and water valve (Use a pan to catch the water).
4. Reconnect the water inlet pipe to the water valve.
5. Remove the filter at the bottom of the tub and use a sponge to soak up water in the sump.

### **⚠ NOTE**

If your dishwasher cannot work because of the ice, please contact authorised service person.

## Cleaning the spray arms

The spray arms can be easily removed for periodic cleaning of the nozzles to prevent possible clogging. Wash them under running water and carefully replace them in their seats, checking that their rotary movement is in no way impeded.

Grasp the middle of the spray arm, pull it upwards to remove it. Wash the arms under a jet of running water and replace it carefully to its seat. After reassembly, check that the spray arms rotate freely. Otherwise, check that they have been installed correctly.

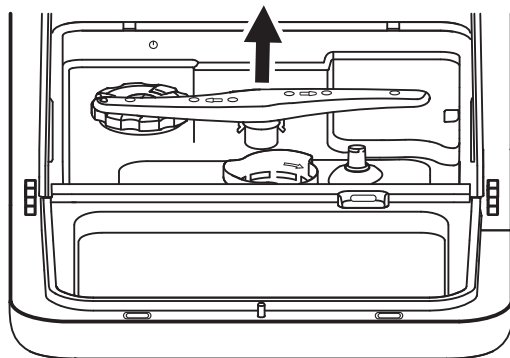

## • **How to keep your dishwasher in shape**

---

### **After every wash**

After every wash, turn off the water supply to the appliance and leave the door slightly open so that moisture and odours are not trapped inside.

### **Remove the plug**

Before cleaning or performing maintenance, always remove the plug from the socket.

### **No solvents or abrasive cleaning**

To clean the exterior and rubber parts of the dishwasher, do not use solvents or abrasive cleaning products. Only use a cloth with warm soapy water.

To remove spots or stains from the surface of the interior, use a cloth dampened with water and a little vinegar, or a cleaning product made specifically for dishwashers.

### **When not in use for a long time**

It is recommended that you run a wash cycle with the dishwasher empty and then remove the plug from the socket, turn off the water supply and leave the door of the appliance slightly open. This will help the door seals to last longer and prevent odours from forming within the appliance.

### **Moving the appliance**

If the appliance must be moved, try to keep it in the vertical position. If absolutely necessary, it can be positioned on its back.

# INSTALLATION

---

## **⚠ WARNING**



### **Electrical Shock Hazard**

Disconnect electrical power before installing dishwasher.

Failure to do so could result in death or electrical shock.

### **⚠ Attention**

The installation of the pipes and electrical equipments should be done by professionals.

## **• Installation preparation**

---

The installation position of dishwasher should be near the existing water inlet tap and drain outlet and power socket.

One side of the cabinet sink should be chosen to facilitate the connection of drain hoses of the dishwasher.

## **• Positioning the Appliance**

---

Position the appliance in the desired location. The back should rest against the wall behind it, and the sides, along the adjacent cabinets or wall. The dishwasher is equipped with water supply and drain hoses that can be positioned to the right or the left to facilitate proper installation.

## • About Power Connection

---

### **⚠ WARNING**

For personal safety:

- Do not use an extension cord or an adapter plug with this appliance.
- Do not, under any circumstances, cut or remove the earthing connection from the power cord.

### Electrical Requirements

Please look at the rating label to know the rating voltage and connect the dishwasher to the appropriate power supply. Use the required fuse 10 amp, time delay fuse or circuit breaker recommended and provide separate circuit serving only this appliance.

### Electrical Connection

Ensure the voltage and frequency of the power being corresponds to those on the rating plate. Only insert the plug into an electrical socket which is earthed properly. If the electrical socket to which the appliance must be connected is not appropriate for the plug , replace the socket, rather than using a adaptors or the like as they could cause overheating and burns.

**⚠ Ensure that proper earthing exists before use**

## • Water Connection

---

Connect the cold water supply hose to a threaded 3/4(inch) connector and make sure that it is fastened tightly in place. If the water pipes are new or have not been used for an extended period of time, let the water run to make sure that the water is clear and free of impurities. If this precaution is not taken, there is a risk that the water inlet can get blocked and damage the appliance.

Please Note: If the supplied hose does not fit your tap, please contact your local plumbing supply center where adapters are available for purchase.

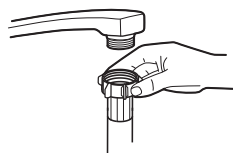

## • Connection of drain hoses

---

Fix the drain pipe with the back pipe of the machine. The interface is fitted with clamps and tightened with a screwdriver.

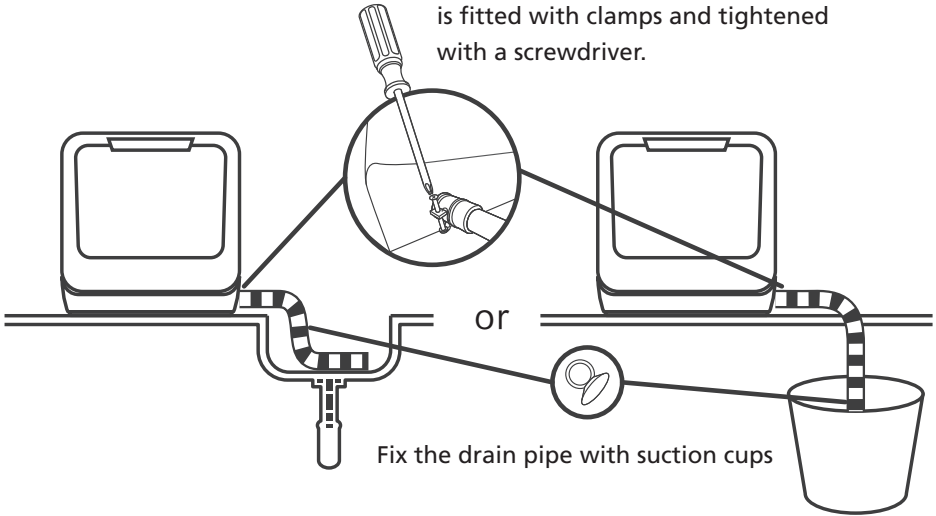

The connection of the drain pipe: Put end of the drain into a sink or bucket.

### How to Drain Excess Water From Hoses

If the sink is more than 1000 mm higher than the floor, the excess water in hoses cannot be drained directly into the sink. It will be necessary to drain excess water from hoses into a bowl or suitable container that is held outside and lower than the sink.

### Water Outlet

Connect the water drain hose. The drain hose must be correctly fitted to avoid water leaks. Ensure that the water drain hose is not kinked or squashed.

### Extension Hose

If you need a drain hose extension, make sure to use a similar drain hose. It must be no longer than 4 metres, otherwise the cleaning effect of the dishwasher could be reduced.



# TROUBLESHOOTING TIPS

## • Before calling for service

Reviewing the charts on the following pages may save you from calling for service.

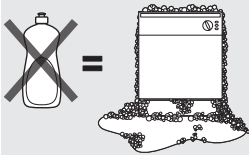
Problem	Possible Causes	What To Do
Dishwasher doesn't start	Fuse blown, or the circuit break tripped.	Replace fuse or reset circuit breaker. Remove any other appliances sharing the same circuit with the dishwasher.
	Power supply is not turned on.	Make sure the dishwasher is turned on and the door is closed securely. Make sure the power cord is properly plugged into the wall socket.
	Error code:E1; Water pressure is low	Check that the water supply is connected properly and the water is turned on.
	Door of dishwasher not properly closed.	Make sure to close the door properly and latch it.
Water not pumped from dishwasher	Twisted or trapped drain hose.	Check the drain hose.
	Filter clogged.	Check and clean the filter.
	Kitchen sink clogged.	Check the kitchen sink to make sure it is draining well. If the problem is the kitchen sink that is not draining, you may need a plumber rather than a serviceman for dishwashers.
Suds in the tub	Detergent is not used correctly Detergent overdue or mouldy 	To avoid suds, use dishwasher's detergent. If it happens, please open the dishwasher door for 20~30 minutes and let the suds evaporate. If there still have suds, please add 1.5 liters of water in the inner tub, close the dishwasher door and run a strong operation of the water discharge until the suds is been cleared. Use the detergent within the period of validity.

<b>Problem</b>	<b>Possible Causes</b>	<b>What To Do</b>
	Spilled rinse-aid.	Always wipe up rinse-aid spills immediately.
Stained tub interior	Detergent with colourant may have been used.	Make sure that the detergent has no colourant.
White film on inside surface	Hard water minerals.	To clean the interior, use a damp sponge with dishwasher detergent and wear rubber gloves. Never use any other cleaner than dishwasher detergent otherwise, it may cause foaming or suds.
There are rust stains on cutlery	The affected items are not corrosion resistant.	Avoid washing items that are not corrosion resistant in the dishwasher.
	A programme was not run after dishwasher salt was added. Traces of salt have gotten into the wash cycle.	Always run a wash programme without any crockery after adding salt. Do not select the Turbo function (if present).
	The lid of the softer is loose.	Check the softener lid is secure.
Knocking noise in the dishwasher	A spray arm is knocking against an item in a basket	Interrupt the programme and rearrange the items which are obstructing the spray arm.
Rattling noise in the dishwasher	Items of crockery are loose in the dishwasher.	Interrupt the programme and rearrange the items of crockery.
Knocking noise in the water pipes	This may be caused by on-site installation or the cross-section of the piping.	This has no influence on the dishwasher function. If in doubt, contact a qualified plumber.
The dishes are not clean	The dishes were not loaded correctly.	See notes in "Loading & unloading your dishwasher".
	The programme was not powerful enough.	Select a more intensive programme.

<b>Problem</b>	<b>Possible Causes</b>	<b>What To Do</b>
The dishes are not clean.	Not enough detergent was dispensed.	Use more detergent, or change your detergent.
	Items are blocking the movement of the spray arms.	Rearrange the items so that the spray can rotate freely.
	The filter combination is not clean or is not correctly fitted in the base of washcabinet. This may cause the spray arm jets to get blocked.	Clean and/or fit the filter correctly. Clean the spray arm jets.
Cloudiness on glassware.	Combination of soft water and too much detergent.	Use less detergent if you have soft water and select a shorter cycle to wash the glassware and to get them clean.
White spots appear on dishes and glasses.	Hard water area can cause limescale deposits.	Add more detergent.
Black or grey marks on dishes	Aluminium utensils have rubbed against dishes	Use a mild abrasive cleaner to eliminate those marks.
Detergent left in dispenser	Dishes block detergent dispenser	Re-loading the dishes properly.
The dishes are not drying	Improper loading	Load the dishwasher as suggested in the directions.
	Dishes are removed too soon	Do not empty your dishwasher immediately after washing. Open the door slightly so that the steam can come out. Take out the dishes until the inside temperature is safe to touch. Unload the lower basket first to prevent the dropping water from the upper basket.

Problem	Possible Causes	What To Do
The dishes are not drying	Wrong program has been selected.	With a short programme, the washing temperature is lower, decreasing cleaning performance. Choose a programme with a long washing time.
	Use of cutlery with a low-quality coating.	Water drainage is more difficult with these items. Cutlery or dishes of this type are not suitable for washing in the dishwasher.

## • Error codes

When some malfunctions come on, the appliance will display error codes to warn you:

Codes	Meanings	Possible Causes
E1	Longer inlet time.	A flow meter, drain valve, or pump failure, it should be repaired by a qualified worker.
E3	Not reaching required temperature	Heating tube or thermistor anomaly, it should be repaired by a qualified worker.
E4	Overflow.	Some element of dishwasher leaks .
E9	Touch button adhesion	Water or other material in the key area causes E9 or it should be repaired by a qualified worker.
E8	Communication anomaly	It should be repaired by a qualified worker.
E6	Water tank float anomaly	It should be repaired by a qualified worker.

### **WARNING**

- If overflow occurs, turn off the main water supply before calling a service.
- If there is water in the base pan because of an overflow or small leak, the water should be removed before restarting the dishwasher.

## • Technical information

---

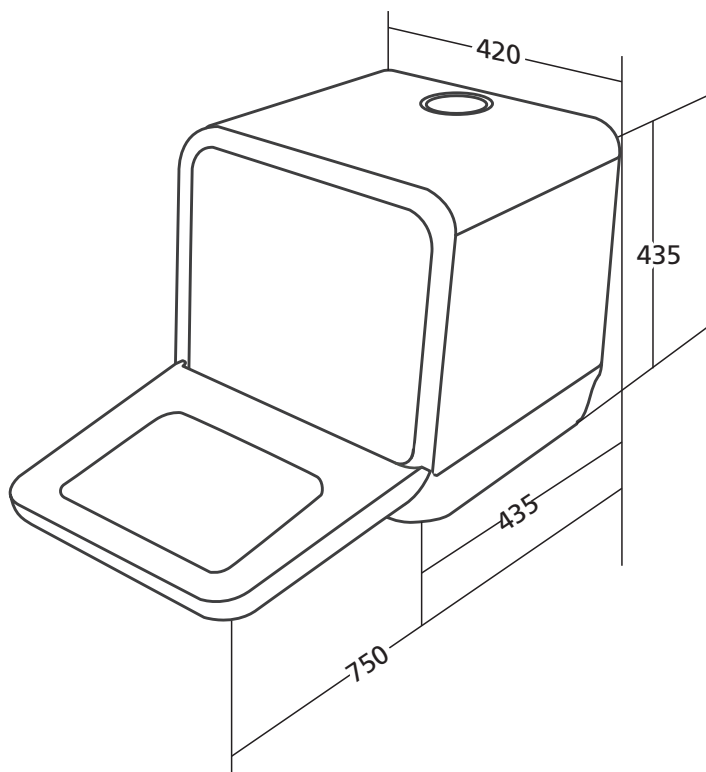

<b>Height</b>	435mm
<b>Width</b>	420mm
<b>Depth</b>	435mm
<b>Voltage connected Load</b>	see rating label
<b>Water pressure</b>	0.04 - 1.0MPa
<b>Power supply</b>	see rating label
<b>Pieces</b>	22 pieces

Equipment name : Dishwasher      Type designation (Type) : HAMDWQP42601SA PC						
Unit	Restricted substances and its chemical symbols					
	Lead (Pb)	Mercury (Hg)	Cadmium (Cd)	Hexavalent chromium (Cr <sup>6+</sup> )	Polybrominated biphenyls (PBB)	Polybrominated diphenyl ethers (PBDE)
Outer door	○	○	○	○	○	○
Handle	○	○	○	○	○	○
Wire	○	○	○	○	○	○
Shell	○	○	○	○	○	○
Inner door	○	○	○	○	○	○
Air breaker	○	○	○	○	○	○
Liner	○	○	○	○	○	○
Switch	○	○	○	○	○	○
Base	○	○	○	○	○	○
Sprayer arm assembly	○	○	○	○	○	○
Top panel ASM	○	○	○	○	○	○
Sump	○	○	○	○	○	○
Rack	○	○	○	○	○	○
Hose	○	○	○	○	○	○
Screw	○	○	○	○	○	○
Wash Pump	○	○	○	○	○	○
Heater	○	○	○	○	○	○
Computer board	Exceeding 0.1 wt %	○	Exceeding 0.01 wt %	○	○	○
Power cord	Exceeding 0.1 wt %	○	○	○	○	○
<p>Note 1 : "Exceeding 0.1 wt %" and "exceeding 0.01 wt %" indicate that the percentage content of the restricted substance exceeds the reference percentage value of presence condition.</p> <p>Note 2 : "○" indicates that the percentage content of the restricted substance does not exceed the percentage of reference value of presence.</p> <p>Note 3 : The "-" indicates that the restricted substance corresponds to the exemption.</p>						



TAIWAN MEIZHI ELECTRICAL CONSUMER CO.,LTD.  
3F, NO.152, Jiankang RD., SongshanDist., TaipeiCity 10586, Taiwan  
Tel: +886-2-27600066  
Fax: +886-2-27660123